

### Lintels Schedule (Refer to Specifications)

| No. | Location      | Catnic Ref. | Notes   |
|-----|---------------|-------------|---|
| L1  | Lounge        | CX90/100    |   |
| L2  | Lounge        | UBs - B1    | Refer to attached Calcs-online specifications which includes padstone sizes & spreader beams. |
| L3  | Kitchen       | UBs - B2    | Refer to attached Calcs-online specifications which includes padstone sizes & spreader beams. |
| L4  | Kitchen       | UBs - B3    | Refer to attached Calcs-online specifications which includes padstone sizes.                  |
| L5  | Kitchen       | CG90/100    |   |
| L6  | Reception     | CX90/100    |   |
| L7  | Reception     | CN102       |   |
| L8  | Utility       | CN102       |   |
| L9  | Utility       | CG90/100    |   |
| L10 | Hall          | UBs - B6    | Refer to attached Calcs-online specifications which includes padstone sizes.                  |
| L11 | Hall          | UBs - B5    | Refer to attached Calcs-online specifications which includes padstone sizes.                  |
| L12 | W.C.          | CN102       |   |
| L13 | Garage        | CN56XA      |   |
| L14 | Garage        | CX90/100    |   |
| L15 | W.C.          | CG90/100    |   |
| L16 | Main Entrance | Beam - T1   | Refer to attached Calcs-online specifications which includes timber beam and posts sizes.     |
| L17 | Store         | CG90/100    |   |
| L18 | Bedroom 4     | CG90/100    |   |
| L19 | Bedroom 4     | CG90/100    |   |
| L20 | Ensuite 4     | CG90/100    |   |
| L21 | Bathroom      | CG90/100    |   |
| L22 | Bedroom 5     | CG90/100    |   |
| L23 | Landing       | UBs - B4    | Refer to attached Calcs-online specifications which includes padstone sizes.                  |
| L24 | Bedroom 2     | CG90/100    |   |

### Notes

All works to be in accordance with the current Building Regulations and British Standards, and to the satisfaction of the Building Control Officer/Inspector and Planning Officer where applicable. Details may be subject to change at the request of the Building Control Officer/Inspector.

The Contractor is responsible for checking all dimensions on site prior to commencement and during the duration of the works with any errors brought to the attention of the Client as soon as possible.

The Contractor shall inspect the property being worked on, all grounds, adjoining properties, public highway, surface and underground services which may be affected by the works and record and report to the Client any defects.

The Contractor shall be entirely responsible for the security, strength and stability of the building(s) during the course of the works which is to include carrying out investigations of the existing structure(s). The Contractor shall allow for the protection of existing groundworks including paving, plants and lawned areas, and to existing fixtures and fittings, by the use of dust sheets, screens etc., and is to make good any damage at their own expense. The site is to be kept in an orderly manner and cleaned/tidied up at the end of each working day.

All relevant security precautions and protection, including against the weather, is to be afforded at the end of each working day. The Contractor is to allow for any liability claims against themselves.

All materials are to be used and installed in accordance with the relevant manufacturer's instructions and recommendations. The quality of any materials shall not be any lower than that defined in the relevant British Standard, current Agreement Certificate or that the material has been satisfactorily assessed by an appropriate independent authority and/or 'CE' marked. Sanitary suite(s) and fittings, electrical fittings and locations, and radiators to be at the Client's requirements. All skirting/architraving to match existing or subject to Client's agreement. All ceiling, walls and floor finishes to Client's requirement. All paint types and colours to Client's requirements.

All Certificates, including the Building Regulations Notice and Electrical, Gas and Heating together with all Warranties to be handed over to the Client upon completion of testing/commissioning.

Refer to dwg. S01 for details of Sections A - A and B - B.

Refer to dwg. SP01 for scheme specifications and attached Structural Engineer's Specifications/Details.

# CONSTRUCTION PLAN - GRD. FLOOR 2 OF 2

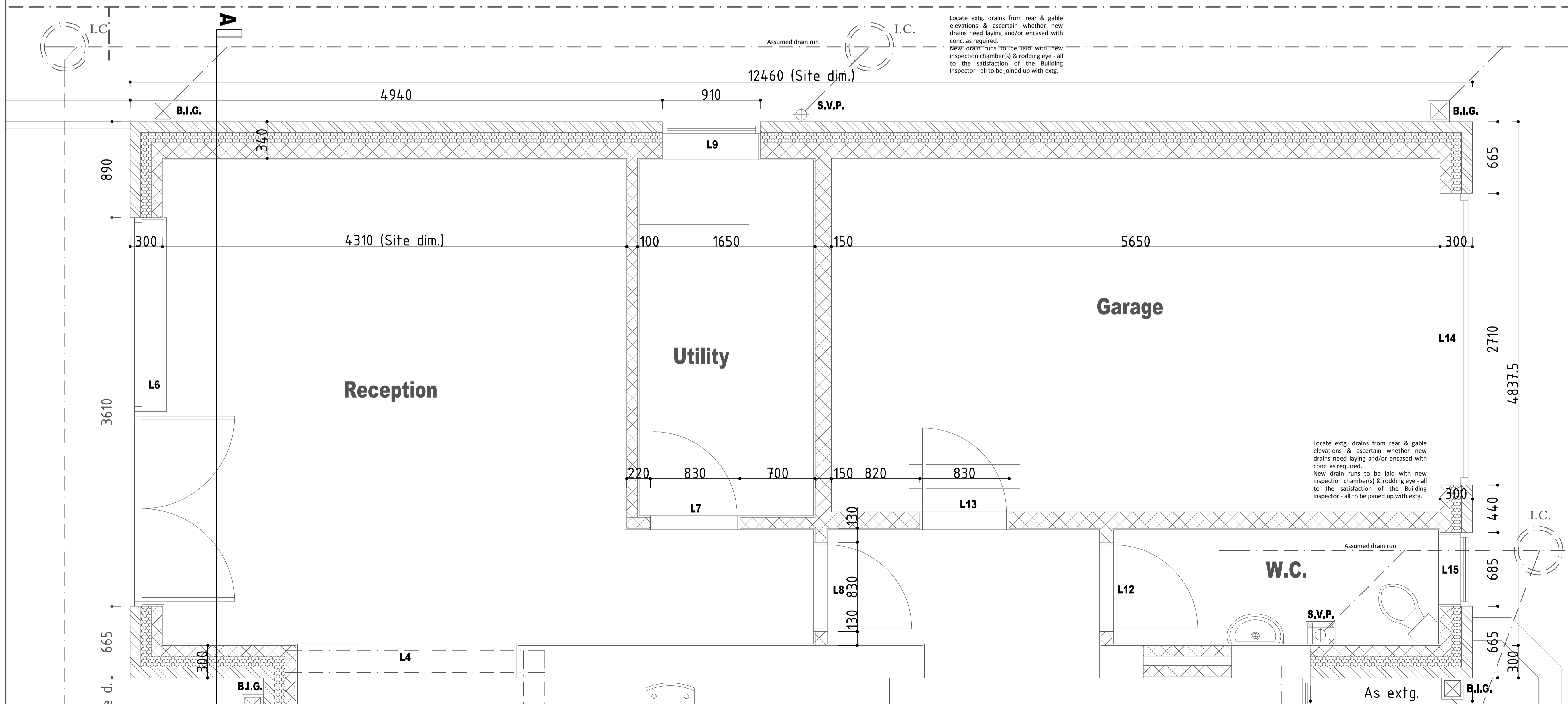

All drawings are the Copyright of JPL Design and Construct. This drawing may not be copied by any third party without prior permission.

| Rev. | Description | Date | By |
|------|-------------|------|----|
|      |             |      |    |
|      |             |      |    |

  
**JPL Design and Construct**  
[www.jpdesignandconstruct.co.uk](http://www.jpdesignandconstruct.co.uk)  
 E-mail [jp@jpdesignandconstruct.co.uk](mailto:jp@jpdesignandconstruct.co.uk)  
 12, Ormskirk Close,  
 Bury, BL8 2JG  
 Telephone 0161 272 0643

|  |  |
|--|--|
| Project<br>Proposed Extensions for<br>Additional Accommodation &<br>Re-modelling<br>Construction Plan - Grd. Flr.<br>1 of 2. | Client<br>Mr. U. Umeadi.<br>Address<br>6, Somerdale Ave.,<br>Bolton,<br>BL1 5HS. |
| Date 07.03.14.   | Dwg no. CP01(2)  |
| Scale 1 : 20 (A1)  | Rev.   |
| Drawn JP   |  |