

FD20

DOORSET TO FIRE RESISTANT REQUIREMENT



SMOKE DETECTION & ALARM SYSTEM



STUDDED PARTITIONS

- 20 Remove
- 206 Repairing Site Following
- 207 Brick External Leaf
- 208 Dry Wall
- 214 Aerated Concrete Block Internal Leaf
- 230 Rolled Steel UBS
- 231 Rolled Steel UBS
- 232 Forthing Openings/Holes
- 330 Particleboard Flooring On Joists
- 355 Particleboard Flooring On
- 377 Site Fabricated Roof Dormer
- 385 Common And Vaulted Roof Rafters
- 386 Plywood Flat Roof Deck On Timber Joists
- 387 Common Rafter And Valley
- 388 Dwarf Partition
- 430 Proprietary Eaves And Bargeboard/Verge
- 500 cm
- 501 Plain Concrete Vertical Tiling To Dormer Cheeks And Face
- 540 Insulation And Vapour Barrier For Common Rafter And
- 541 Insulation And Vapour Barrier For Common Rafter And
- 590 PVCU Rainwater System

- 572 Roof Windows To Common Rafter And Vaulted Roof
- 575 Combined Roof Windows To Common Rafter And Vaulted Roof
- 580 Roof Window To Common Rafter And Vaulted Roof
- 585 Roof Balcony Window To Common Rafter And Vaulted Roof
- 590 Proprietary PVCU Window
- 620 Plasterboard Dry Lining And Skim
- 630 Timber Stud Partition With Plasterboard And Skim
- 640 Pipe Ducts
- 650 Softwood Skirtings and Architraving
- 675 Plasterboard And Skim To Masonry Walls
- 680 Internal Wood Panelled Doorset
- 720 Emulsion Paint To New/Existing Plastered Walls
- 730 Ceramic Tiling On Internal Walls
- 740 Ceramic Tiling
- 750 Emulsion Paint To New/Existing Plastered Ceilings
- 770 Install W.C. And Bathrooms Suites
- 830 Extend Central Heating Pipework
- 840 New LST Steel Panel radiators
- 850 Towel Warmer Radiators
- 855 Auto mist system
- 860 Extract Fan In External Cavity Wall - W.C., Bathrooms, And Ensuite.
- 865 Photovoltaic Modules
- 930 Downlight And Uplight Luminaires
- 950 Television Sockets

Notes
All works to be in accordance with the current Building Regulations and British Standards, and to the satisfaction of the Building Control Officer and Planning Officer where applicable.

All materials are to be used and installed in accordance with the relevant manufacturer's instructions and recommendations. The quality of any materials shall not be any lower than that defined in the relevant British Standard, or that the material has been satisfactorily assessed by an appropriate independent authority.

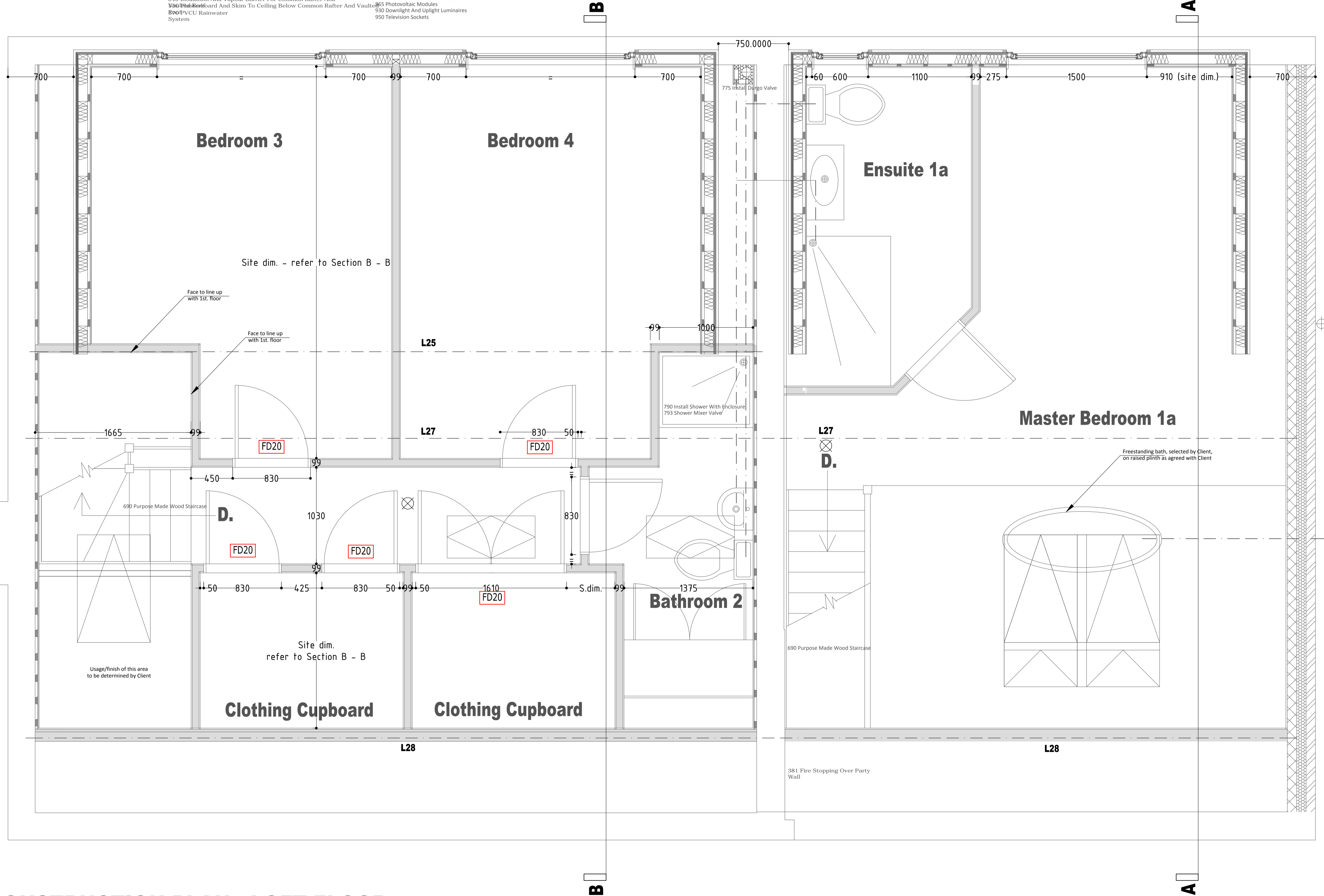

All drawings are the Copyright of JPL Design and Construct. This drawing may not be copied by any third party without prior permission.

| Rev. | Description | Date | By |
|------|--|-----------|----|
| A | Flat roof dormers omitted & pitched dormers added in lieu. | 26.11.13. | JP |



JPL Design and Construct
www.jpdesignandconstruct.co.uk
E-mail jp@jpdesignandconstruct.co.uk
119, Rufford Drive, Whitefield, Manchester, M45 8PD
Telephone 0161 766 3843

| | |
|--|--|
| Project Proposed Gable Extensions & Loft Conversion & Re-modelling Construction Plan - Loft Floor. | Client Mr. & Mrs. W. Shaffer. Address 12, Ringley Close, Whitefield, Manchester, M45 7HR. |
| Date 26.11.13. Scale 1 : 20 (A1) Drawn JP | Drawing no. CP03 Rev. A |

CONSTRUCTION PLAN - LOFT FLOOR